

IN LINE ROTATING COUPLING



GGL

Flow Upto 700 LPM
Pressure 400 bars

Description & Operation

These valves are mounted between the end of a flexible hose and a fixed component to compensate hose's rotations and torsions and to prevent its damage. They are not suitable for fast and continuous rotations. They are used in every application where systems have flexible moving hoses are used. In line mounting. Connect ports P to the uses.

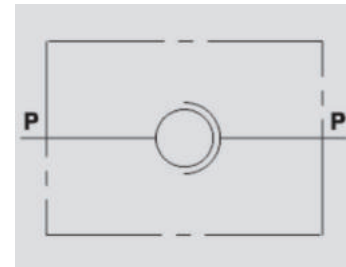

Hydraulic Symbol

Technical Data

Maximum Flow	700 LPM
Max. Operating Pressure	400 Bar
Body Material	Steel
Internal parts	Hardened and Ground steel
External Component treatment	Zn/Fe - standard (96h) / Zn/Ni (720h)
Oil Temperature	50 Deg. C
Fluids	Mineral based or synthetics with lubricating properties
Viscosity	30 cSt
Standard Sealing	NBR-Buna N
Filtration	20/18/15 ISO 4406 (Max. Filtration admitted)
Orientation / Mounting	Inline
Weight	See Ordering details

Specifications

Type	Max Flow	Max Rotation Pressure	Max Pressure
	LPM	Bar	Bar
GGL 1/4"	25	200	400
GGL 3/8"	35	200	400
GGL 1/2"	60	150	300
GGL 3/4"	100	150	300
GGL 1"	180	100	300
GGL 1" 1/4	270	100	300
GGL 1" 1/2	350	80	300
GGL 2"	700	50	250

 Dimensional Drawing

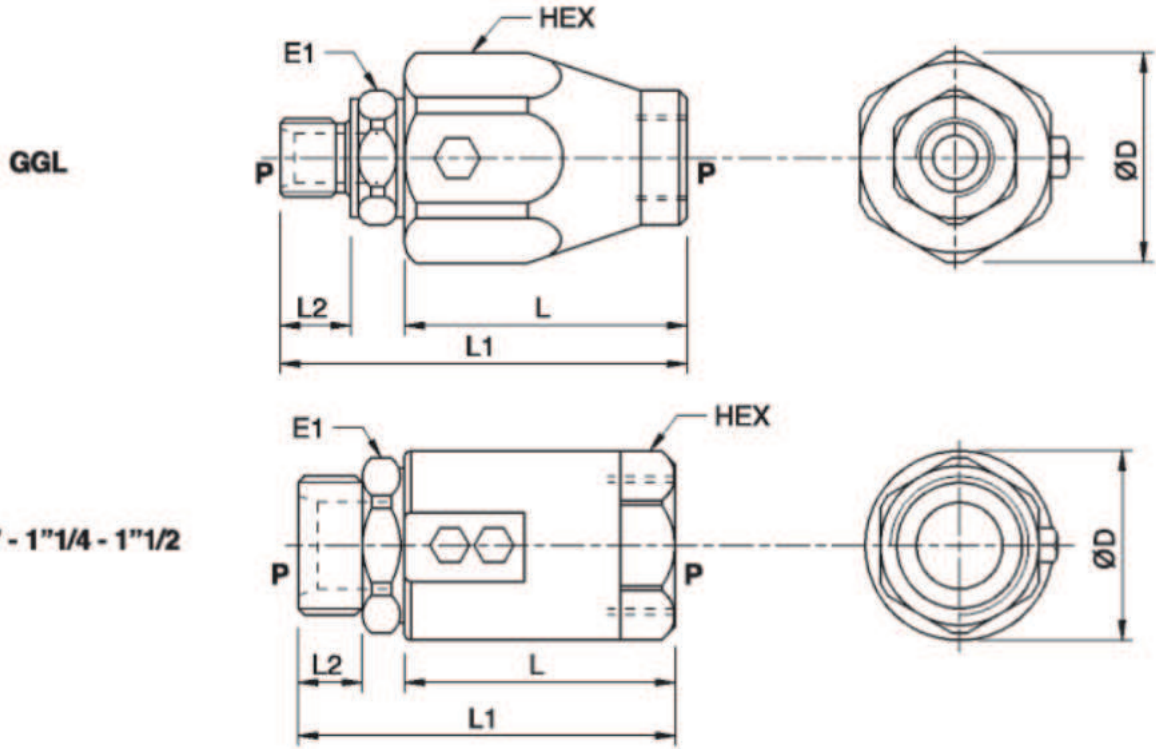

 Ordering Details

Code	Type	P	L	L1	L2	E1	HEX	ØD	Weight
		GAS	mm	mm	mm	mm	mm	mm	Kg
R-G1050	GGL 1/4"	1/4"	42	61	11	19	30	33	0.206
R-G1060	GGL 3/8"	3/8"	44	66	14	24	34	37	0.264
R-G1070	GGL 1/2"	1/2"	47	71	15	27	36	40	0.338
R-G1080	GGL 3/4"	3/4"	60	89	19	34	45	49.5	0.808
R-G1090	GGL 1"	1"	65	98	21	41	50	54.5	0.910
R-G1091	GGL 1 1/4"	1 1/4"	63	101	24	50	55	59.5	1.100
R-G1092	GGL 1 1/2"	1 1/2"	70	110	25	55	65	69.5	1.610
R-G1093	GGL 2"	2"	75	119	28	65	75	84.5	2.490

 On Request

- NPT thread (code GN...instead of G...example: GGL 1/4" NPT code = GN1050)
- GX Inox (code GX...instead of G...example: GGL 1/4" INOX code = GX1050)