



CCR0AD

14W or 19W – Continuous duty – ED100%
Robust design with outer metal cage

Description & Operation

External plated metal cage and shims to maximize electromagnetic output. Metal parts protected against oxidation according to RoHS directive. Bore size: Ø16.1 mm. Suitable for HEAVY DUTY operations.



Technical Data

Power	14W or 19W
Various Voltage Options Available	Both AC and DC
Coil Insulation Class	H (180°C)
Wire Insulation Class	H (180°C)
ED	100%
Supply Power Tolerance	±10%DC; +10% -5%AC
Ambient Temperature Range	-40°C. 80°C
IP coil with connector	See page
IP coil	69k
Weight	0.21kg

Dimensional Drawing

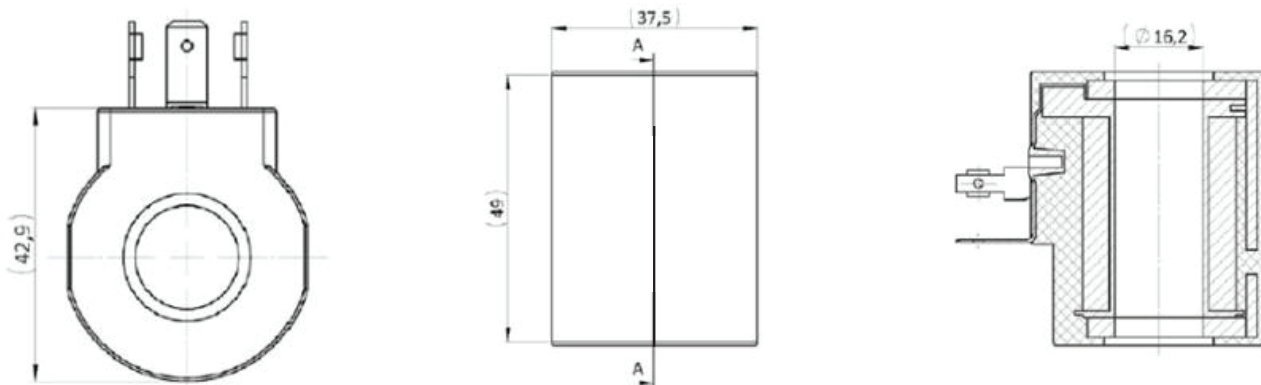

 **Performance Details**

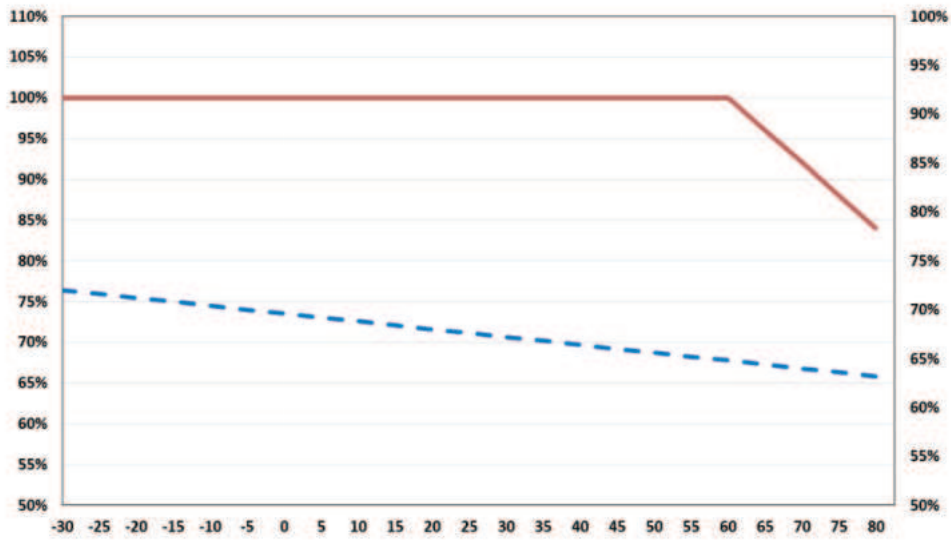

 **Ordering Code**

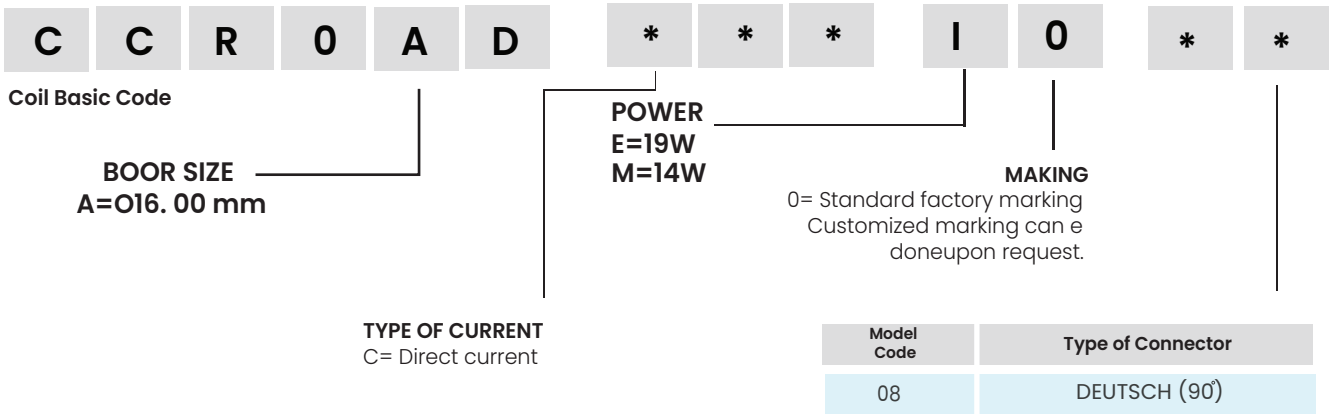

COILS